

DOCTORS EDEN

Own your dream piece of land on **OMR !**

DTCP Approved Layout on OMR

Developed & Promoted by

Location Benefits:

Medical Colleges & Hospitals:

- Chettinad Hospital and Research Institute
- Shri Sathya Sai Medical College

Educational Institutions:

- PSBB Millennium School
- Gateway American International School
- SSN College of Engineering
- Sathyabama University
- VIT University Chennai Campus
- Hindustan Institute of Engineering Technology

And many more institutions

Ease of Access:

Our project has two access

- From OMR
- From Kelambakkam to Thiruporur Bypass Road

Project Features:

- Gated Community
- Bitumen Top Roads with Road Guards
- Exclusive Allocation of space for EB Transformer
- Avenue Trees
- Fully Fenced
- Borewell
- Space for Common Activities

Approvals:

- Directorate of Town and Country Planning (DTCP)
- Real Estate Regulatory Authority (RERA)
- 75% Funding from HDFC and other reputed Banks and Financial Institutions

DOCTORS EDEN - Layout

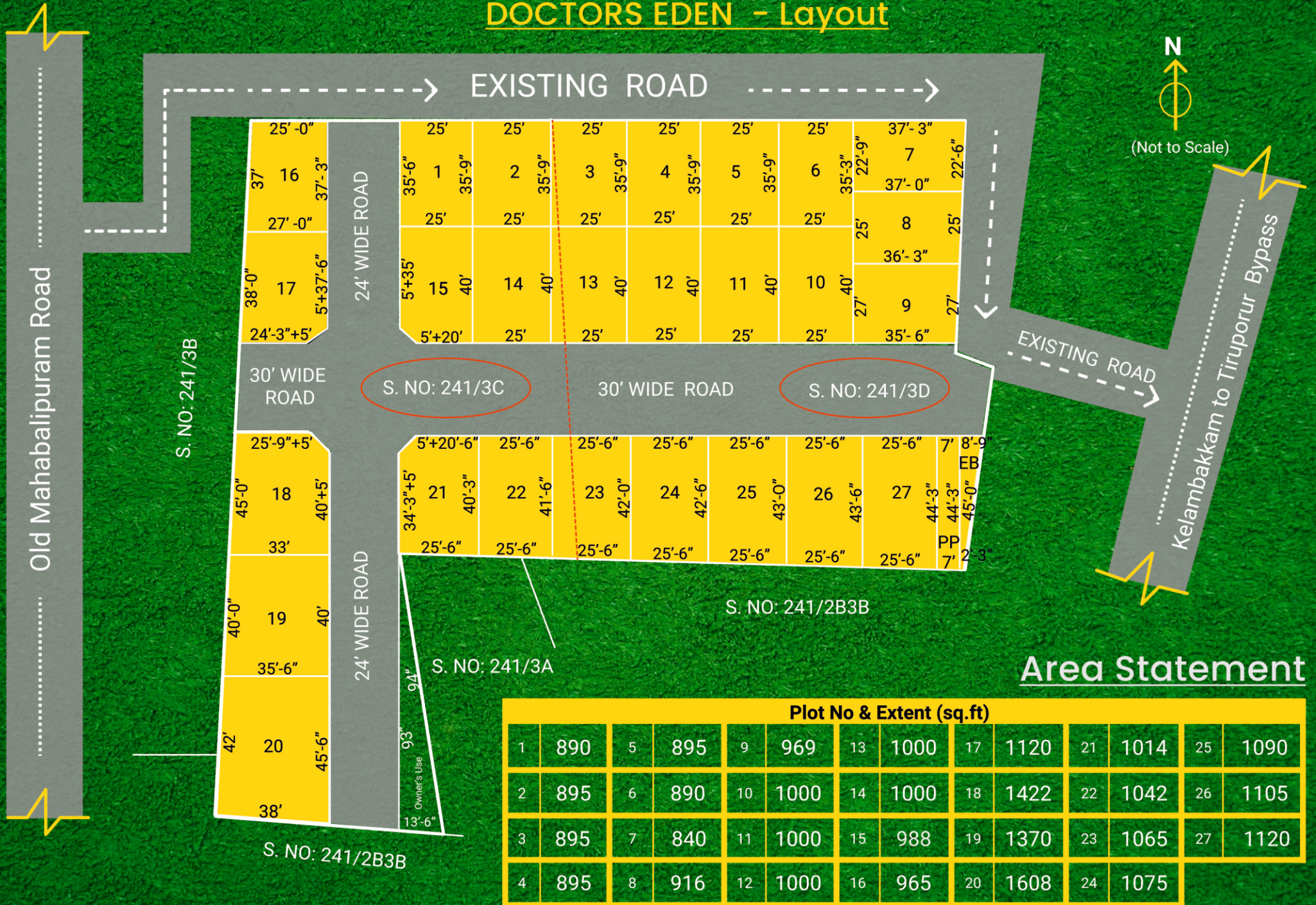

Area Statement

Plot No & Extent (sq.ft)													
1	890	5	895	9	969	13	1000	17	1120	21	1014	25	1090
2	895	6	890	10	1000	14	1000	18	1422	22	1042	26	1105
3	895	7	840	11	1000	15	988	19	1370	23	1065	27	1120
4	895	8	916	12	1000	16	965	20	1608	24	1075		

DOCTORS EDEN - Location Map

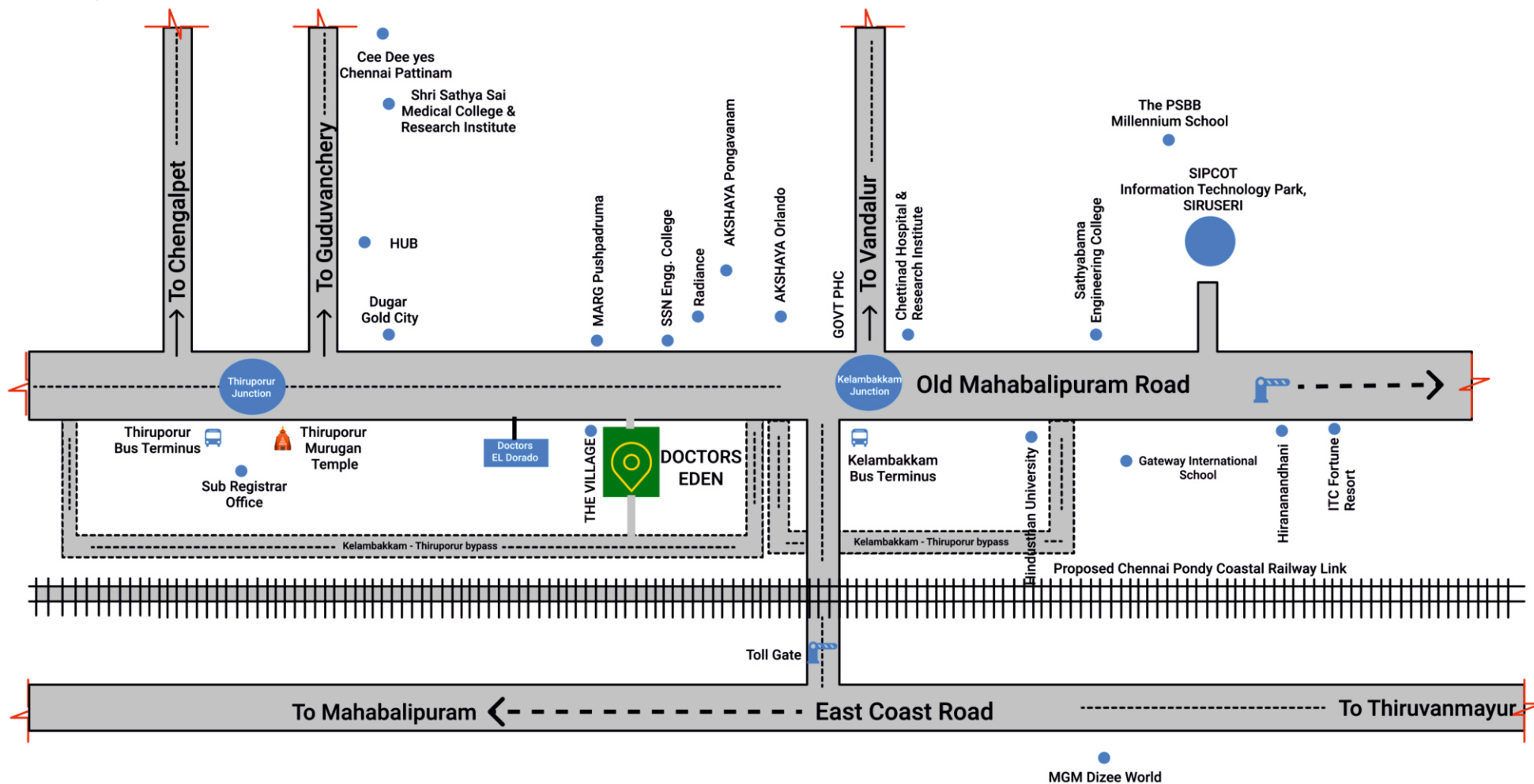

Address

Plot no. 1717, Door no.15, H-Block, 10th Street,
Anna Nagar, Chennai - 600 040

Contact

Phone: 95001 11128 / 96000 12370
E- mail: dr@dhept.com